

AQVA WALL

*Designed and Engineered
to last*



Next Gen
HPL Shower Panels & Back Splash

CROWN XCL
XTERIOR COMPACT LAMINATES

www.royaletouche.com



*Designed and Engineered
to last*

AQVAWALL from Crown Decor is a melamine surfaced high pressure laminate sheet particularly designed for wet areas where moisture resistance is important. These sheets are robust, water, moisture, impact resistant and easy to maintain.

The core of these walls are usually black but can also be supplied in Natural, White and close to matching colour of the surface design. The walls are non bending and maintains complete flatness after the application. The surface has high impact resistance which enables it to have supporting framework spaced between 400-500mm.

Our tile effect wall panels have all the visual benefits of real tiles. These are affordable substitute to ceramic tiles. These waterproof panels are easy to install and clean.

We can offer these walls in 6 surface structure in more than 100 colours/designs. Aqvawall can be used in the wet areas. It can also withstand more than normal resistance to saturated moisture.

Available Sizes

1220 x 2440 mm

Thickness

2.5 mm, 3 mm, 4 mm.



Applications

- Shower Cubicle Lining, Bathrooms and laundrates
- Backwall over sinks, Basin and Laundry Troughs
- Interior wall Lining for Buses, Coaches, Boats, Carvans and likewise
- Shopping area backwall, Supermarket back wall including that in commercial spaces
- Interior wall panelling, partitioning, utility areas etc

SURFACE FINISH



WF



STONE



SQUARE



DD



METRO



GLOSS

COLOUR RANGE



RT 1374



RT 1524



RT 1541



RT 1551



RT 1552



RT 1540

COLOUR RANGE



COLOUR RANGE

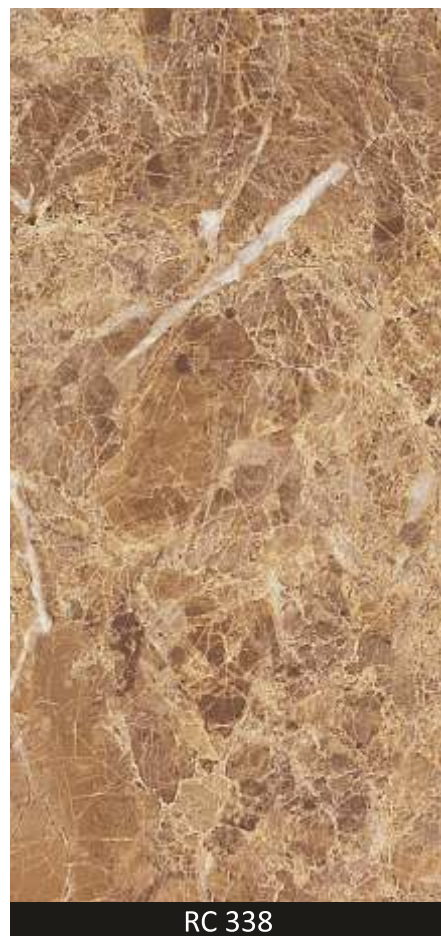

TECHNICAL SPECIFICATIONS

PROPERTIES	SPECIFIED VALUE AS PER EN - 438		ROYALE TOUCHE VALUE
Thickness	EN 438-2 section 5	According to the required thickness	02.0 < t < 03.0 mm : ± 0.20 mm 03.0 < t < 05.0 mm : ± 0.30 mm
Density	ISO 1183-1	1.4	Min. 1.45GM/CM3
Resistance to Surface Wearing	EN 438-2:2005 section 10	Revolutions (min.) Starting Point Wear Value	560 750
Determination of Surface Scratch	EN 438-2:2005 section 25	Stress Rating (min.) Smooth Finished	Flat Surface 5N
Impact Resistance	EN 438-2 Big Ball section 21 CGS 2.0<t<6.0 mm t>6.0 mm	Dropheight - 1800 cm Diameter of Indentation - 10 mm	1800 cm 5 mm
Resistance to dry heat (180°C)	EN 438-2:2005 section 16	Appearance Rating (min.) Gloss Finish Other Finish	4 (black samples/matte finish)
Water Vapour Resistance	EN 438-2:2005 section 14	Appearance Rating (min.) Gloss Finish Other Finish	5 (black samples/matte finish)
Resistance to Boiling Water	EN 438-2 section 12	Mass Increase 5% Thickness Max 6 Appearance Less than 4	2.2%
Determination of Resistance to Burning Cigarettes	EN 438-2:2005 section 30	Level 3	Level 2
Resistance to Staining	CES Group 1 & 2 Group 3	Level 5 Level 4	Level 4 Level 5



ACCESSORIES

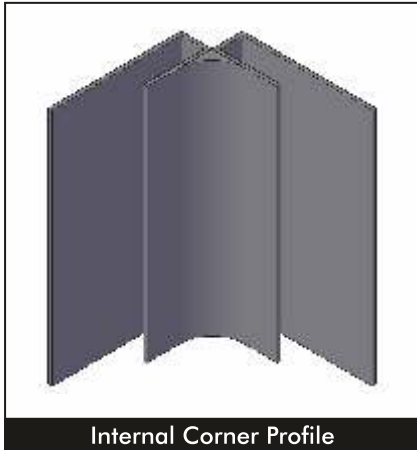

Internal Corner Profile



External Corner Profile

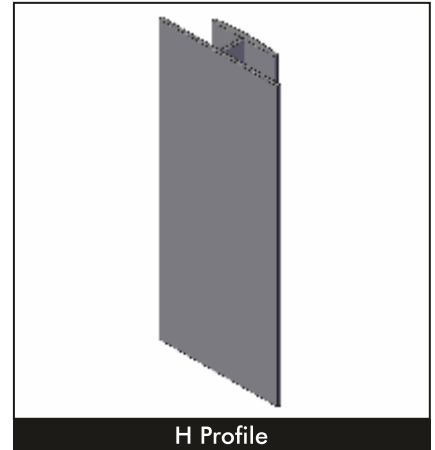

H Profile

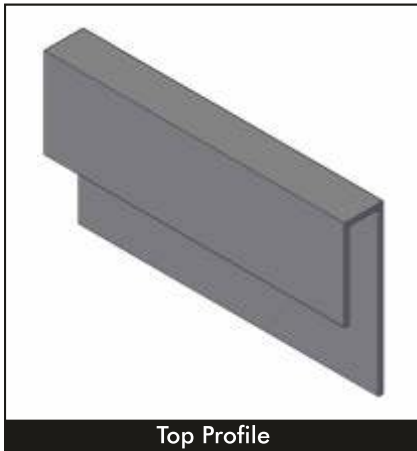

Top Profile

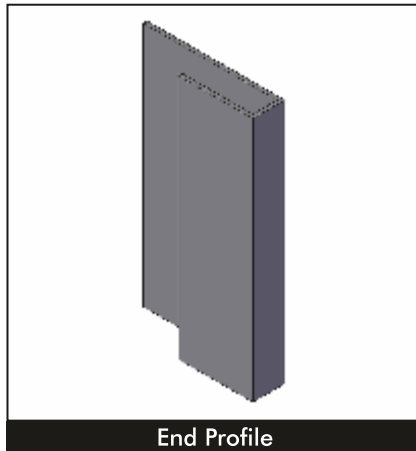

End Profile

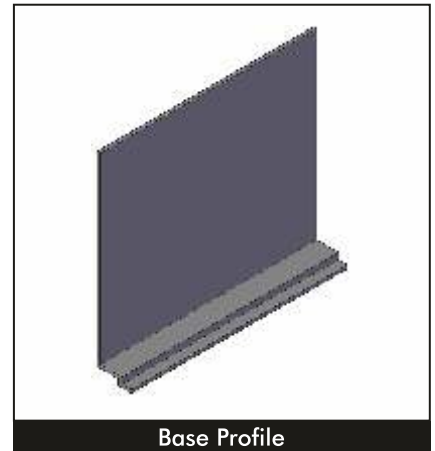

Base Profile

HANDLING AND LOGISTIC GUIDELINES

Handle Aqva Wall panels with care in order not to damage the edges and scratch the surface. In spite of hard surface and protection film cover, the stack weight or improper handling may damage the surface. Avoid any form of dirt or dust between the panels. They must be secured against slippages during transit, loading and unloading. The panel should be lifted and not pulled or pushed over the edges.

Stock the panels horizontally on flat and stable surface, with a top cover plate which should be weighted down. Store them in close room under normal climate condition.

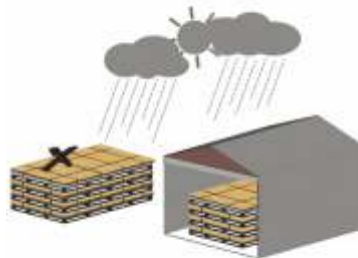
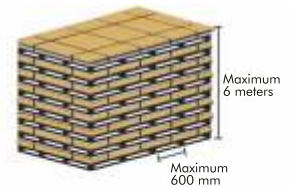

INSTALLATION



Start from one corner of the wall / surface by nailing / screwing / fixing an internal corner profile.

Note : For accessory refer Internal Corner Profile



Apply the silicon sealant inside of each profile (Internal Corner) leaving 3 mm gap for expansion.

Note : For accessory refer Internal Corner Profile

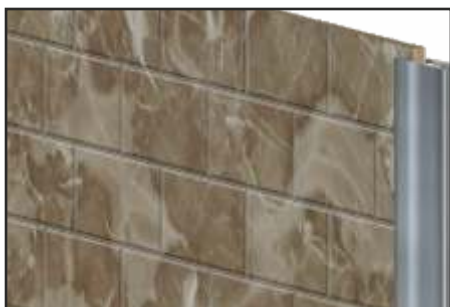

Slide the panel into the profile and position the panel properly. Then fix the next profile leaving space from the edge (as shown in picture) then press the sheet in the fitting for proper fixing.

Note : For accessory refer H Profile



Maintain a gap of 3mm while inserting the panel into the fitting for expansion margin. Then nail the profile to the surface.

Note : For accessory refer H Profile



Top and bottom edge should also be fitted with relative profile keeping in mind a requirement of 11 mm insertion i.e. the panel should be 11 mm longer from the vertical profile.

Note : For accessory refer Top Profile



The gaps of all the base panel should be filled with silicon from each side of the wall.

Note : For accessory refer Base Profile

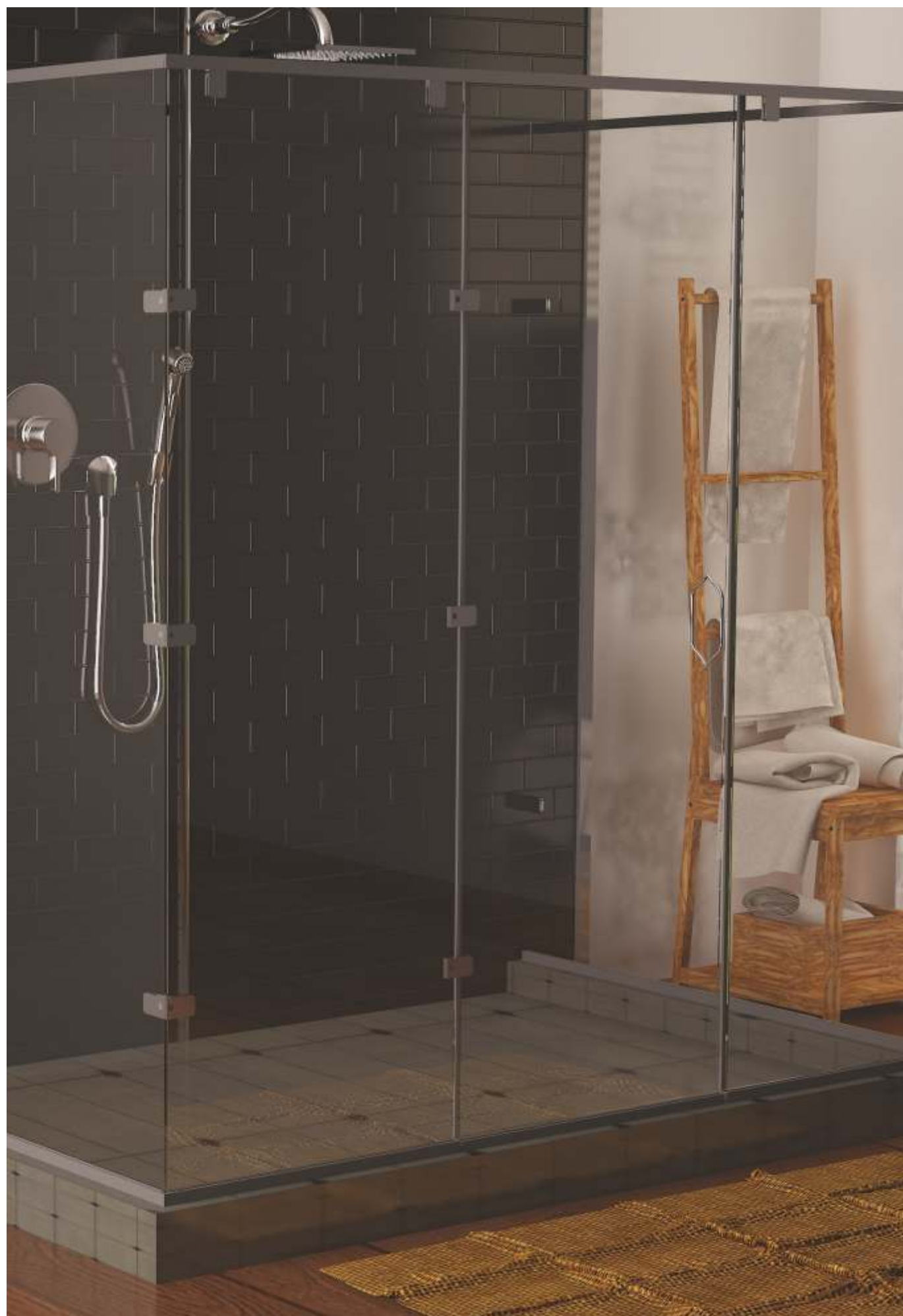













CROWN DÉCOR PVT.LTD.

6 Patel Avenue, 1st Floor,
S.G. Highway, Near Gurudwara,
Ahmedabad - 380 059, Gujarat, India.
Contact : +91 79 4001 7979

FACTORY

419/1, Radhe Industrial Estate,
Tajpur Road, Dist. Ahmedabad
Changodar - 382 213, Gujarat, India.

MARKETING OFFICE

2/A N Malayalay, 2nd Floor,
3 Woodburn Park, Kolkata - 700 020, India.
Ph : +91 33 4066 0166, 2283 0166
E-mail : kanishka@royaletouche.com